

Ultrasonic Humidifier

CAUTION: READ MANUAL CAREFULLY FOR PROPER PROCEDURES AND OPERATION.

INTRODUCTION

Thank you for purchasing your new SimpleMist Ultrasonic Humidifier!

The SimpleMist Ultrasonic Humidifier is designed for both living and sleeping areas and humidifies areas up to 400 sq. ft. It features a timer for ease of use and aromatherapy to freshen up your living space.

Please read this owner’s manual to fully understand all of the operational features and safety instructions for the unit.

If you have any questions concerning this product, contact Customer Service by calling toll free 1-888-236-7231 or our website www.allergybuyersclub.com.

TABLE OF CONTENTS

Introduction.....	2
Specifications	3
Important Safety Instructions	4
Product Content & Features	5
Operational Placement & Parts Diagram	6
Getting Started	7, 8
Control Panel/ Product Operation	9
Water Level Indicator	10
Anti-Splash Function	10
Power Off/Storage	11
Product Maintenance	12
Troubleshooting	13
Warranty	14, 15

	CORRECT DISPOSAL OF THIS PRODUCT
	This marking indicates that this product should not be disposed with other household wastes. To prevent possible harm to the environment or human health from uncontrolled waste disposal, recycle it responsibly to promote the sustainable reuse of material resources.

Please recycle per local city/country/state laws in the U.S.

SPECIFICATIONS

Model:	SimpleMist KR003
Rated Voltage:	DC 24V
Rated Power:	20 W
Operating Time:	≥17H
Noise Levels (decibels):	≤38dB
Coverage Area:	Up to 400 sq. ft. (Up to 37m ²)
Weight:	3.5 lbs. (1.6 kg)
Dimensions:	6.7" x 6.7" x 13.6" (17 x 17 x 34.5 cm)
Water Tank Capacity:	1.3 gallons (5.0 L)
Humidification Mode:	High: 300ml/h Medium: 200ml/h Low: 100ml/h
Timer:	2/4/6/8/10/12 Hours

IMPORTANT SAFETY INSTRUCTIONS

READ ALL INSTRUCTIONS BEFORE USING THIS PRODUCT

 **WARNING:** Important Safety Instructions to reduce the risk of fire, electrical shock, or injury.

 **WARNING:** Only use the SimpleMist Ultrasonic Humidifier indoors. Improper use can be hazardous for your health and can lead to injury.

Your safety and the safe operation of this humidifier are very important to us. All safety and operating instructions should be read, adhered to and followed before the unit is operated. Incorrect operation may cause harm or damage.

- Repairs to the unit should only be made by a qualified, professional and authorized repairman. Improper repair work can cause danger to the user
- Make sure humidifier is powered off and unplugged from the wall outlet before moving the unit
- To prevent damage, remove all packaging from the humidifier prior to turning on the unit
- Only operate the humidifier when it is fully assembled
- Do not use outdoors or on wet surfaces
- Place the humidifier on a hard protective (waterproof) surface to ensure optimal performance, prevent tipping and damage to flooring or furniture
- Do not wring, pinch, bend, or twist the power cord
- Do not drag the power cord when it is disconnected from the wall outlet
- Never use the humidifier if there is damage to the unit or the power cord
- To avoid electrical shock, do not touch the humidifier, power cord or plug when your hands are wet
- Only connect the humidifier to a 110-120V power source – do not use with other equipment
- Only use the AC 24V 1A power cord that came with the unit
- Always unplug the humidifier before moving it or adding water
- Do not use the humidifier if it is making an abnormal sound or has an abnormal smell
- Do not put fingers or any foreign objects into the inlet or outlet of the humidifier, as this can cause electric shock or damage to the humidifier
- Do not allow humidifier to be used as a toy. Close supervision is necessary when operated near children
- Use clean tap water to reduce scale on the transducer.
- Do not use distilled or reverse osmosis filtered water in this product.
- Do not use softened water in this product.
- Do not pour water into the mist outlet. Only fill water into the water tank.
- Humidifier should be thoroughly cleaned every 1 to 2 weeks, depending upon water quality. More frequent cleanings may be necessary.
- For safety, always remove cover when filling the water tank, while avoiding the mist outlet. Water that is poured into the mist outlet may cause electrical damage or leakage.
- Only clean using soap and warm water. Make sure to completely rinse the unit surfaces so there is no soap residue left in unit when turned back on.

SAVE THESE INSTRUCTIONS

PRODUCT CONTENT & FEATURES

ACCESSORIES:

- Aromatherapy Cotton Pad (1)
- Cleaning Brush
- Adapter – AC 100V ~ 240V
- Water Level Float
- Ceramic Ball Water Softening Filter

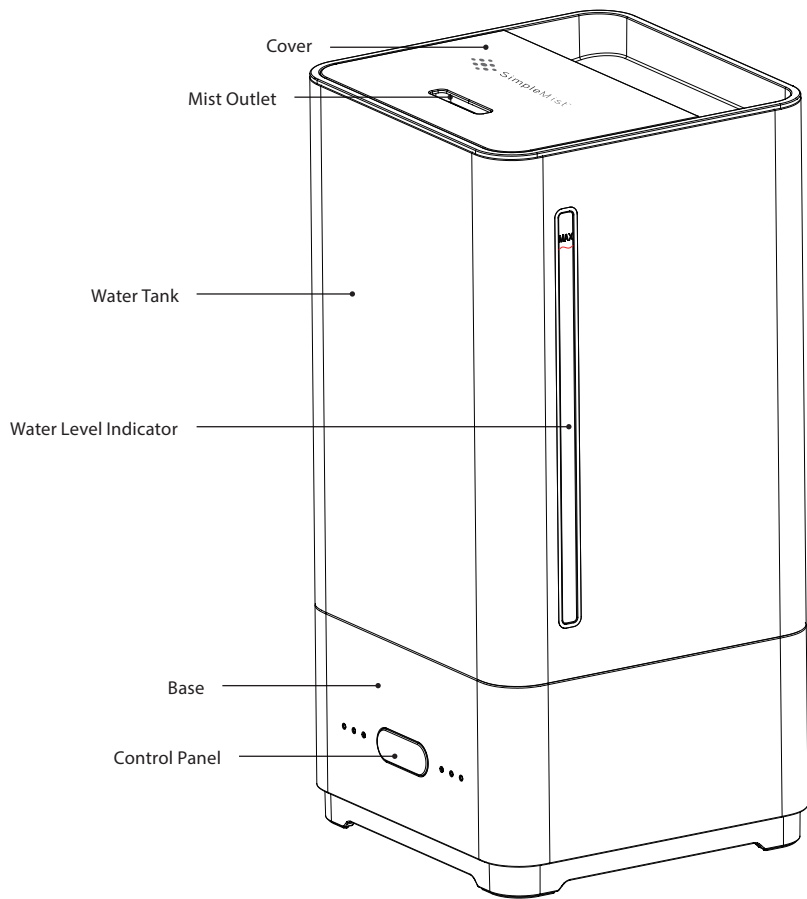

FEATURES:

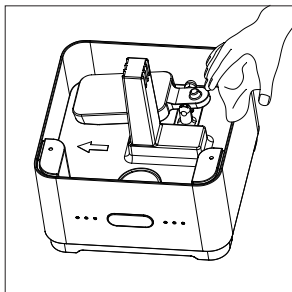

CLEANABLE

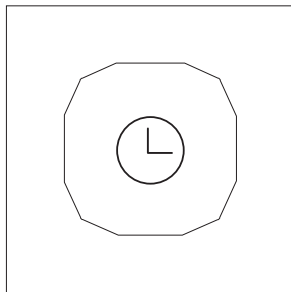

TIMER

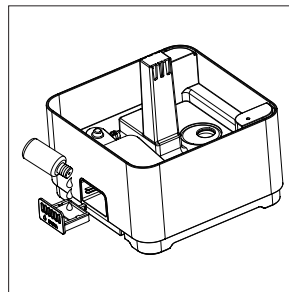

AROMATHERAPY

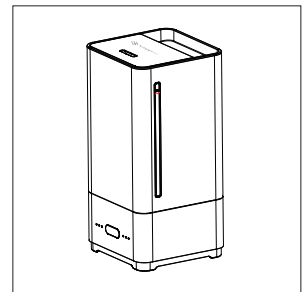

WATER LEVEL INDICATOR

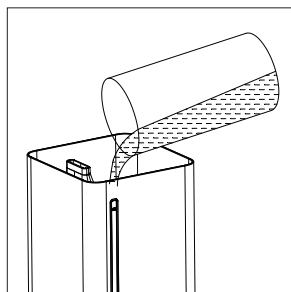

TOP REFILL

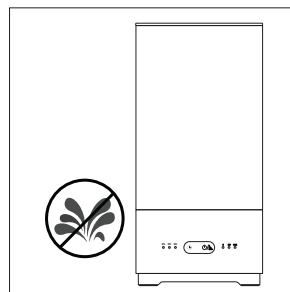

ANTI-SPLASH

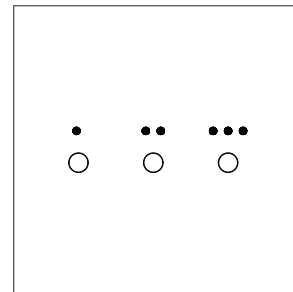

HIGH CAPACITY MIST OUTPUT

OPERATIONAL PLACEMENT & PARTS DIAGRAMS

Your safety and the safe operation of this humidifier are very important to us. All safety and operating instructions should be read, adhered to and followed before the unit is operated. Incorrect operation may cause harm or damage.

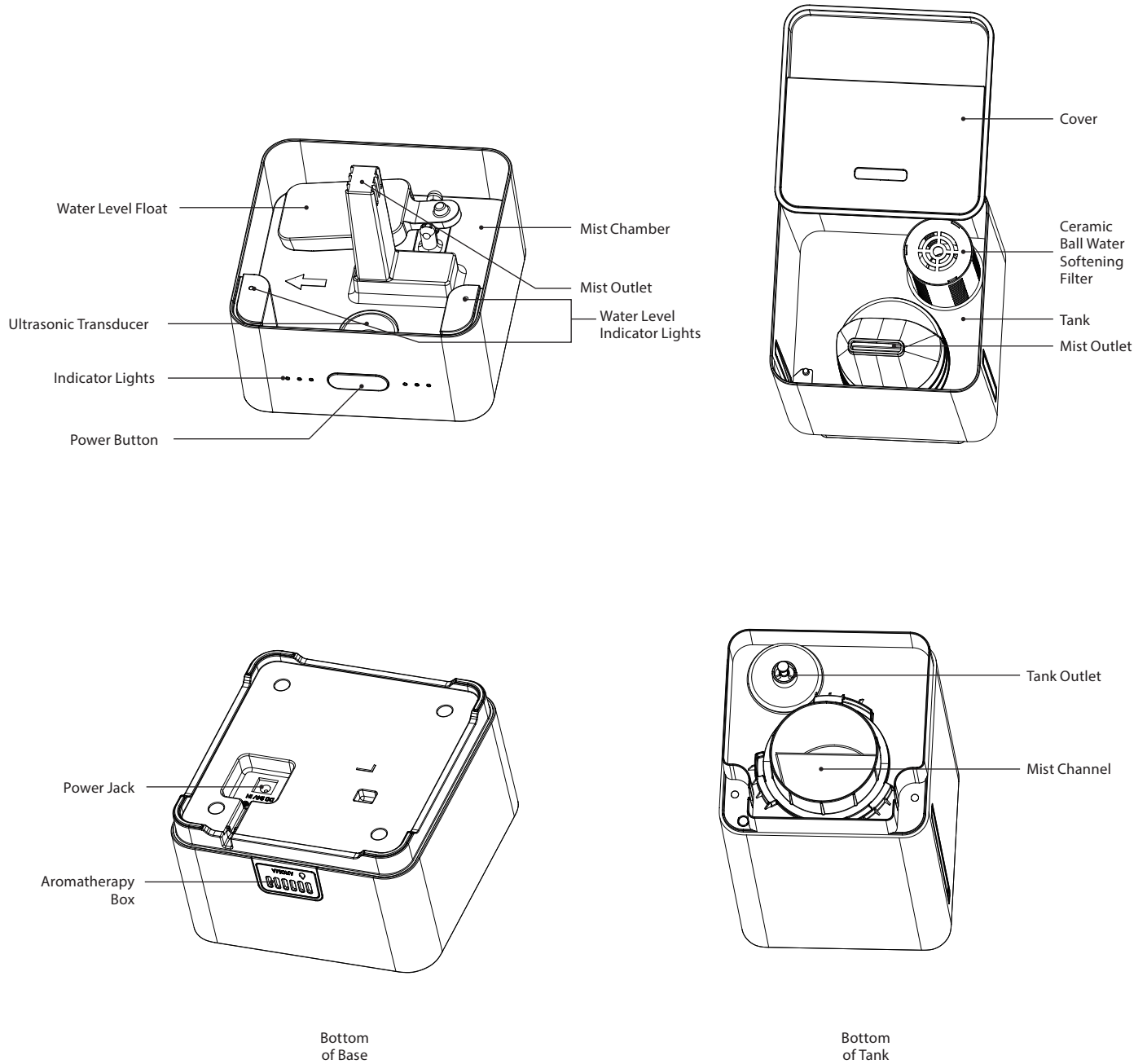

GETTING STARTED

NOTE: Before using your humidifier, remove all packaging from the filters.

Step 1: Open the package; install the Water Level Float on the Water Level Float Bracket as shown.

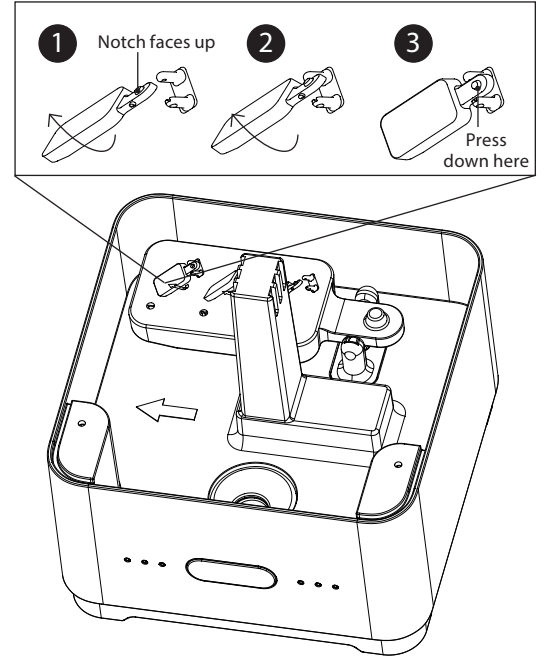

! CAUTION: When installing the Water Level Float, make sure the Water Level Float Axis and the Water Level Float Bracket are in the correct direction according to the different size of the holes, otherwise it may cause water leakage.

Step 2: Turn the humidifier base over and plug the Power Adapter into the bottom of the humidifier base. Fit cord into notch at bottom of base.

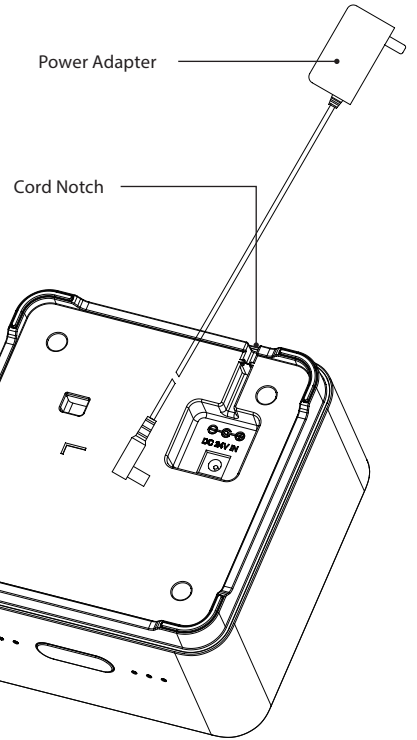

Step 3: Insert the Ceramic Ball Water Softener Filter into the filter ring at the bottom of the Water Tank.

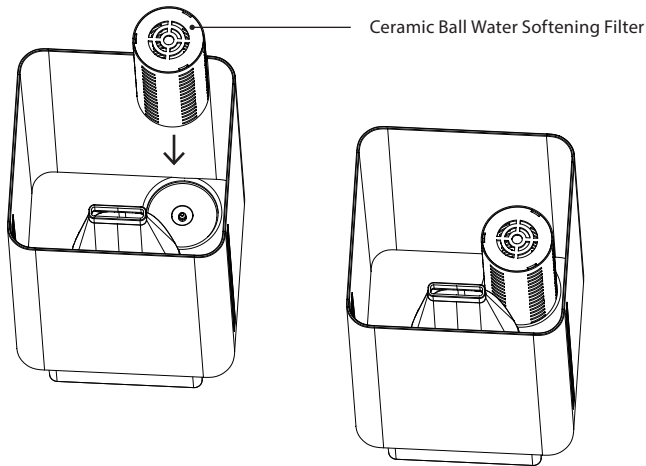

GETTING STARTED (CONTINUED)

Step 4: Place the Water Tank on top of the base and then fill the tank with clean water.

Pay attention to not exceed the maximum water level, which is marked on the side of the Water Tank.

CAUTION: Always remove cover and fill the Water Tank while avoiding the mist outlet. Water that is poured into the mist outlet may cause electrical damage or leakage.

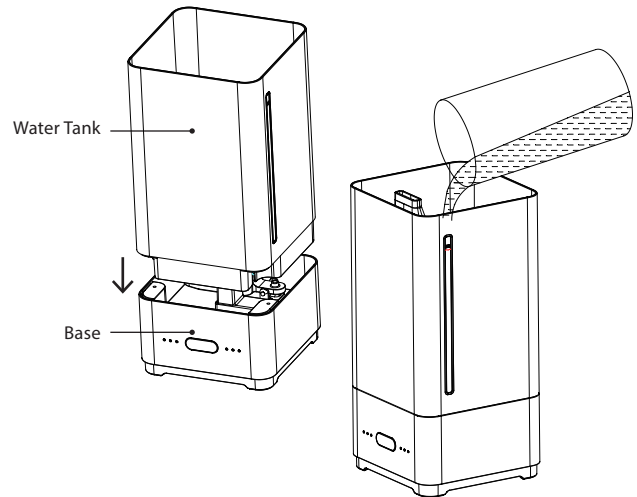

NOTE: Always add clean, cool water to water tank.

NOTE: If the Water Tank runs out of water, add more water to maintain desired humidity.

Step 5: Cover the Water Tank, plug in the power, and the product is ready to use.

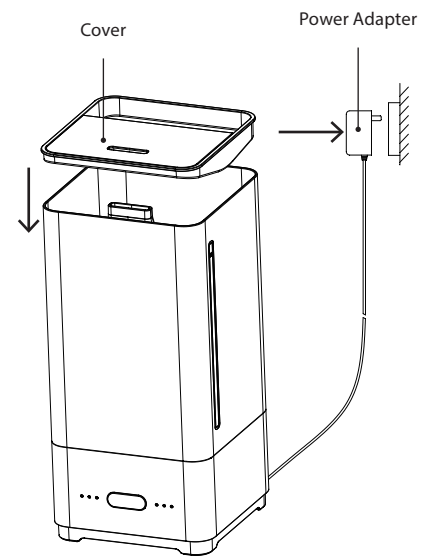

AROMATHERAPY

If aromatherapy is desired, remove the Aromatherapy Box by pressing on it. Carefully add 2 to 3 droplets of 100% essential oil onto the supplied aromatherapy cotton pad. Push box in when done, until locked into place. Do not use without SimpleMist aromatherapy cotton pads. The aroma will be diffused into the mist when the humidifier is operating.

NOTE: The aromatherapy cotton pad can be used repeatedly. We recommend to replace it every month. Replacement pads can be purchased at www.allergybuyersclub.com. Only use the official cotton pads specifically designed for the SimpleMist.

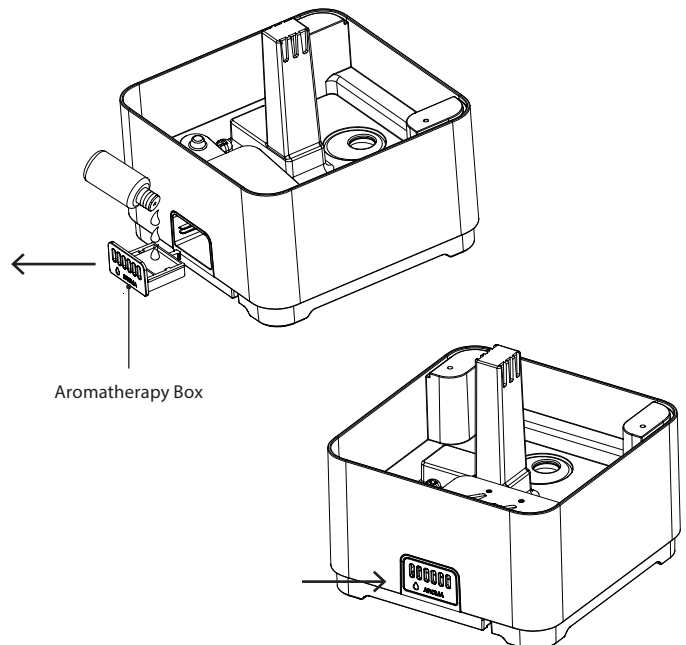

CONTROL PANEL OPERATION

NOTE: Indicator lights will only illuminate when the humidifier is plugged in and the power is turned on.

POWER/MIST BUTTON

Press the Power/Mist Button to turn on the humidifier.

1. Press the Power/Mist Button one time to set the humidifier to the low mist setting.
2. Press the Power/Mist Button a 2nd time to set the humidifier to the medium mist setting.
3. Press the Power/Mist Button a 3rd time to set the humidifier to the high mist setting.
4. Press the Power/Mist Button a 4th time to turn the humidifier off.

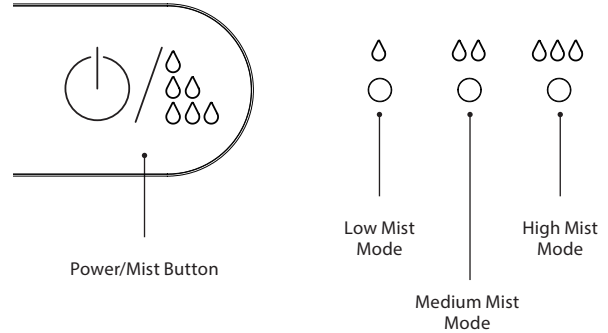

NOTE: The Indicator Lights turn off immediately. It takes several minutes to power off the fan.

TIMER BUTTON

When the humidifier is first turned on, the humidifier will be set to the 12 hour timer setting.

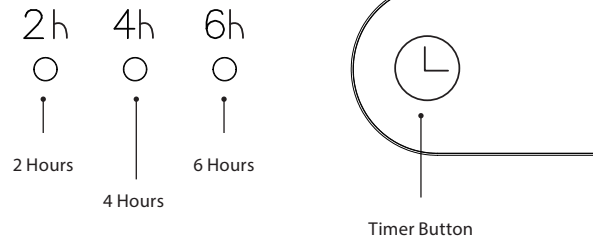

1. Press the Timer Button once to set the humidifier to the 2 hour timer setting.
2. Press the Timer Button a 2nd time to set the humidifier to the 4 hour timer setting.
3. Press the Timer Button a 3rd time to set the humidifier to the 6 hour timer setting.
4. Press the Timer Button a 4th time to set the humidifier to the 8 hour timer setting (2h and 6h light up).
5. Press the Timer Button a 5th time to set the humidifier to the 10 hour timer setting (4h and 6h light up).
6. Press the Timer Button a 6th time to set the humidifier to the 12 hour timer setting (2h, 4h and 6h light up).

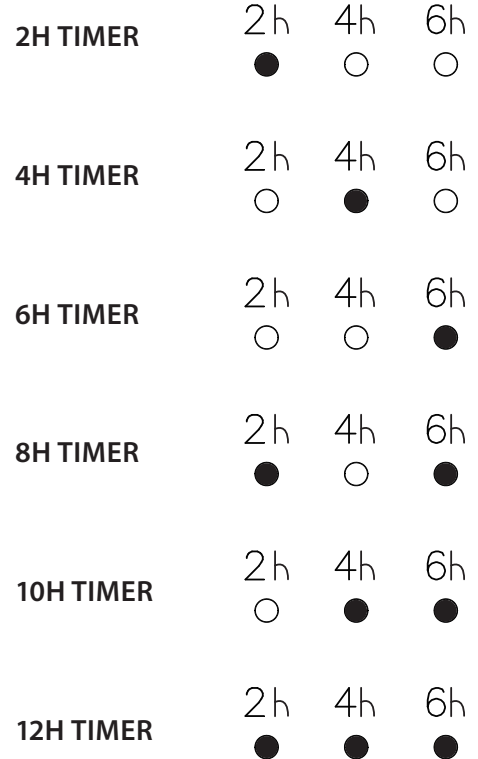

WATER LEVEL INDICATOR

With the humidifier powered on, press and hold the Timer Button for 1.5 seconds to turn the Water Level Indicator Lights ON.

Press and hold again for 1.5 seconds to turn the Water Level Indicator Lights OFF.

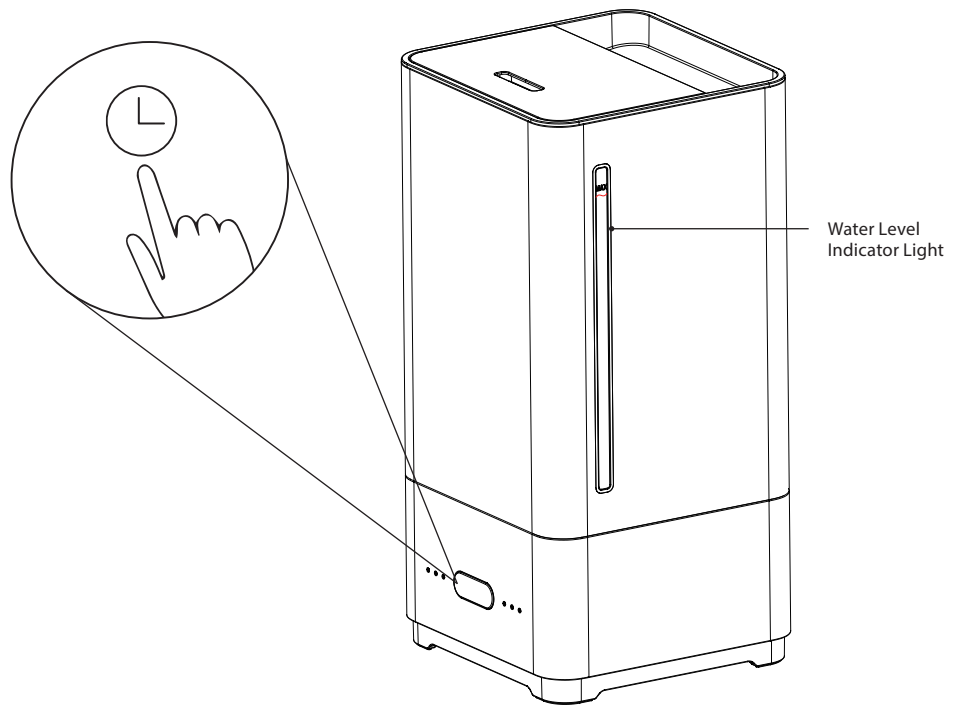

ANTI-SPLASH FUNCTION

Any time the tank is removed while the humidifier is operating, the mist function will automatically turn off. The mist function will resume within 3 seconds after the tank is reinstalled properly.

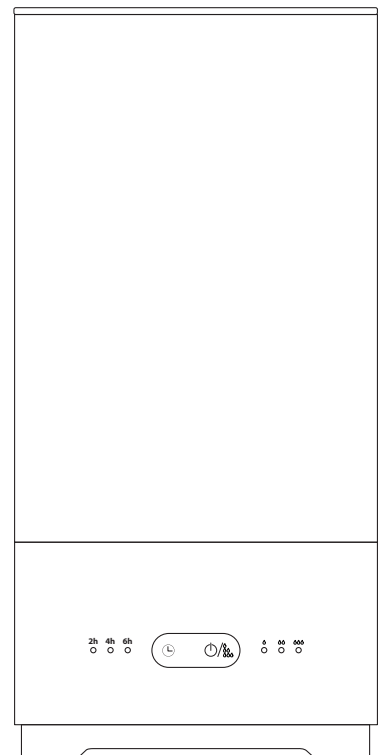

POWER OFF/STORAGE

Press and hold the Power/Mist Button for 1.5 seconds to turn off the humidifier.

NOTE: The Indicator Lights turn off immediately, but it takes several minutes to power off the fan.

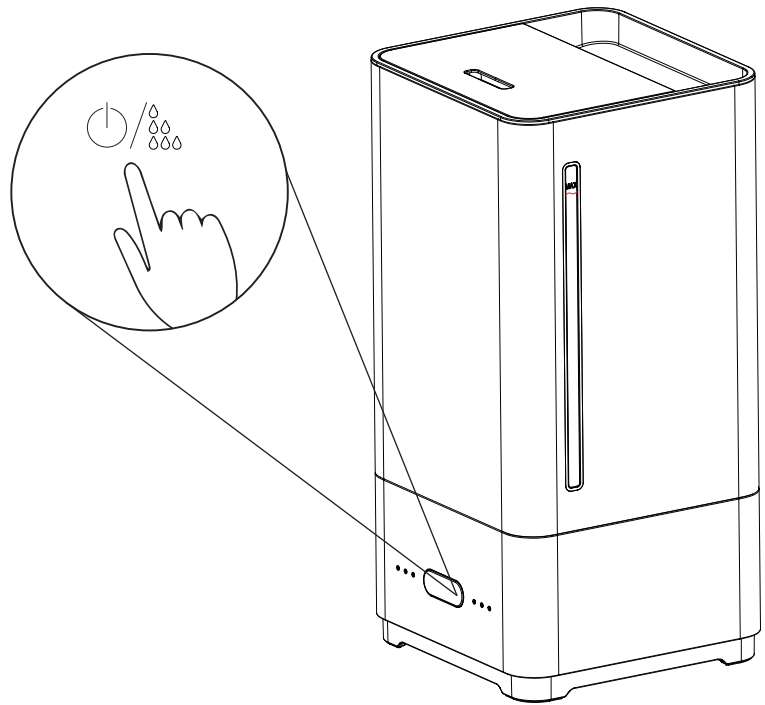

PROCEDURE FOR STORAGE OR AN EXTENDED PERIOD OF NON-USAGE:

1. Remove the power plug and unplug from the electrical outlet.
2. Remove the tank and pour out any remaining water.
3. Allow tank to dry.
4. Using a soft cloth, wipe the base dry.

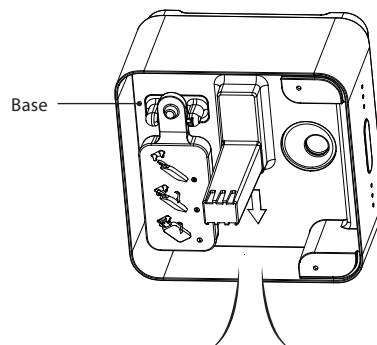
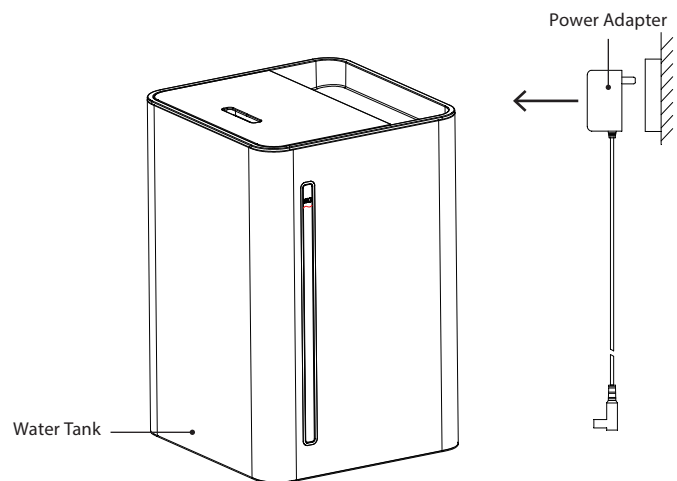

PRODUCT MAINTENANCE

 **WARNING:** Disconnect plug from power source!

PREPARING THE HUMIDIFIER BASE FOR CLEANING:

Detach the Water Level Float according to the diagram.

NOTE: The included Cleaning Brush can be used for cleaning all parts of the humidifier.

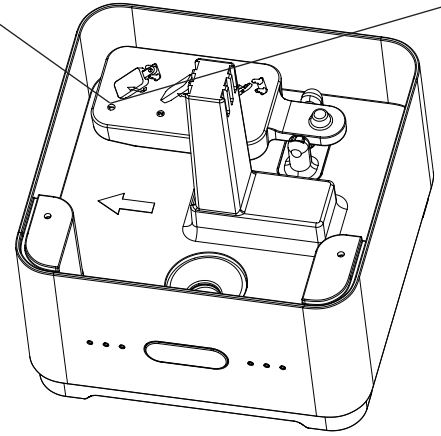
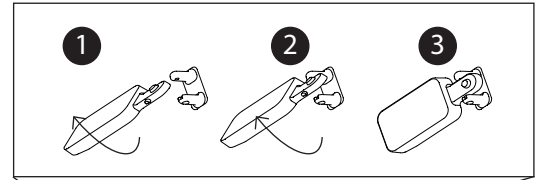
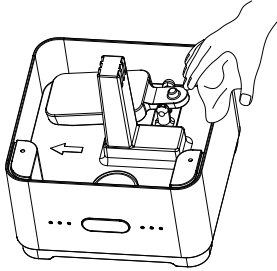

GENERAL CLEANING INSTRUCTIONS:

1. Clean residue thoroughly with a wet towel and dry the humidifier base with a soft clean cloth or towel. Set aside to dry completely.
2. The Water Tank and Cover can be cleaned using mild dish soap, rinse well and dry with a soft clean cloth or towel.

 **WARNING:** Do not wash base under running water.

CLEANING THE CERAMIC BALL WATER SOFTENING FILTER:

Clean and re-activate the water-softening filter every 30 – 45 days

1. Remove the Water Softening Filter from the tank cover
2. Soak the Water Softening Filter in a 50/50 water and white vinegar mixture for approximately 10 minutes
3. Remove the Water Softening Filter from the water and white vinegar solution and thoroughly rinse with cool, clean water
4. The Water Softening Filter is now ready for continued use.

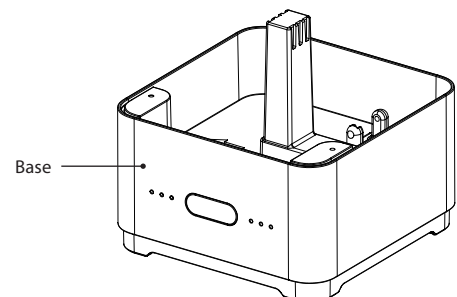
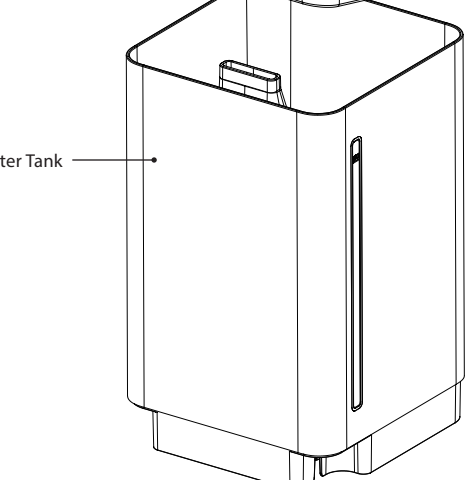
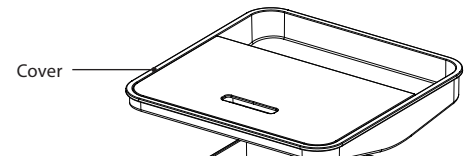

TROUBLESHOOTING

⚠ WARNING: Please do not disassemble the SimpleMist Humidifier or service yourself. If these corrective actions do not solve the problem, please contact Customer Service by calling toll free 1-888-236-7231 or our website at www.allergybuyersclub.com.

FAULT	CAUSE	TREATMENT
Low Mist Output	<ol style="list-style-type: none"> 1. Set to LOW mist level. 2. The air inlet at the bottom is blocked. 	<ol style="list-style-type: none"> 1. Adjust the mist mode to a higher level. 2. Make sure the inlet is not blocked.
No Mist Output When Turned On	<ol style="list-style-type: none"> 1. No water in the tank. 2. Filled with pure water so the water shortage sensor cannot work properly and the transducer is spoiled. 	<ol style="list-style-type: none"> 1. Fill the tank with water. 2. Contact Customer Service.
Low Mist Volume After Long Term Use	<ol style="list-style-type: none"> 1. Scaling of minerals inside the product affects the atomization efficiency. 2. The transducer has aged. 3. Dust gathering at the air filter, blocking the air inlet. 	<ol style="list-style-type: none"> 1. Remove the scale with a weak white vinegar & water solution, and then rinse with water. 2. Contact Customer Service. 3. Clean the air inlet.
Water Leakage	<ol style="list-style-type: none"> 1. Tank is not correctly installed. 2. The tank outlet's seal ring is improperly installed. 3. Foreign body stuck inside the tank outlet, outlet valve stuck. 	<ol style="list-style-type: none"> 1. Reinstall the tank properly to make sure there is a good contact between the tank and the base of unit. 2. Adjust the seal ring to make it seal properly. 3. Clean the tank and outlet valve to ensure that the outlet valve is operating correctly.
Unit Does Not Turn On After Pressing The Power Button	<ol style="list-style-type: none"> 1. Product is not plugged in. 2. Product has experienced an electrical glitch. 	<ol style="list-style-type: none"> 1. Check if the power plug is plugged in. 2. Unplug the power cord and power on again to reset the humidifier.

LIMITED 1 YEAR WARRANTY

Customer should not repackage and ship the SimpleMist Humidifier due to possibility of irreparable damage. For warranty service, please contact Customer Service by calling 1-888-236-7231 or visit www.allergybuyersclub.com.

WHAT IS COVERED BY THIS WARRANTY

We warrant the SimpleMist Humidifier to the Customer, subject to the conditions herein, against defects in workmanship and material, for a period of one (1) year from the date of Customer's original retail purchase.

INSTALLATION AND MAINTENANCE REQUIREMENTS

This warranty is expressly conditioned upon proper installation, operation, cleaning, and maintenance, all in accordance with the Owner's Manual. Failure to meet any of these requirements will void this warranty. Servicing of your SimpleMist Humidifier by parties other than our authorized representatives and/or using parts other than genuine parts will also void this warranty.

HOW TO OBTAIN WARRANTY SERVICE

Customer must contact Customer Service by calling 1-888-236-7231 or by visiting www.allergybuyersclub.com and provide proof of purchase within the above time periods. We will repair or replace, and return the product, without charge and within a reasonable period of time, subject to the conditions herein, if our examination shall disclose any part to be defective in workmanship or material. If we, in our discretion, are unable to repair the product after a reasonable number of attempts, we will provide either a refund of the purchase price or a replacement unit, at the company's option.

WHAT IS NOT COVERED BY THIS WARRANTY

Not for commercial use. Ordinary wear and tear shall not be considered a defect in workmanship or material. These warranties do not apply for loss or damage caused by accident, fire, abuse, misuse, improper installation, leaking, modification, misapplication, or any repairs other than those provided by our authorized Service Center. This warranty is non-transferable and does not cover consumable items such as filters, softeners or aromatherapy pads.

UNAUTHORIZED CHANNELS

Warranties are voided if a product is purchased through unauthorized channels; this includes websites that are not authorized to use our trademarked names, images, and logos as well as Internet auction sites (e.g. eBay and Craigslist).

EXCLUSION OF OTHER WARRANTIES & CONDITIONS

EXCEPT AS PROVIDED HEREIN, WE MAKE NO REPRESENTATION OR WARRANTY OF ANY KIND. ALL OTHER WARRANTIES OF ANY KIND, EXPRESS OR IMPLIED, ARE HEREBY EXPRESSLY DISCLAIMED, INCLUDING ANY IMPLIED WARRANTY OF MERCHANTABILITY OR FITNESS FOR A PARTICULAR PURPOSE.

LIMITED 1 YEAR WARRANTY (CONTINUED)

LIMITATION OF LIABILITY FOR SPECIAL, INCIDENTAL, OR CONSEQUENTIAL DAMAGES

WE SHALL NOT IN ANY CASE BE LIABLE FOR SPECIAL, INCIDENTAL, OR CONSEQUENTIAL DAMAGES ARISING FROM BREACH OF EXPRESSED OR IMPLIED WARRANTIES, CONDITIONS, GUARANTEES, OR REPRESENTATIONS, BREACH OF CONTRACT, NEGLIGENCE, OR ANY OTHER LEGAL THEORY. SUCH EXCLUDED DAMAGES INCLUDE, BUT ARE NOT LIMITED TO, LOSS OF PROFITS OR REVENUE, AND LOSS OF THE USE OF THE PRODUCTS, AND ANY LOSS CAUSED BY LEAKS OR OTHER WATER DAMAGE.

FOR U.S. APPLICATION ONLY

This warranty gives you specific legal rights, and you may also have other rights which vary from state to state. Some states do not allow limitations on warranties, or on remedies for breach. In such states, the above limitations may not apply to you.

If any provision of this warranty or part thereof is held by a court of competent jurisdiction to be invalid, illegal, or unenforceable, the validity, legality and enforceability of the remaining provisions or parts thereof will not in any way be affected or impaired within the jurisdiction of that court. This entire warranty shall continue to be valid, legal, and enforceable in any jurisdiction where a similar determination has not been made.

This warranty is provided by:

Aerus Health Direct, LLC

300 East Valley Drive

Bristol, VA 24201 (in US)

SERVICE

Every effort is made to ensure customers receive an up-to-date owner's manual on the use of our products; however, from time to time, modifications to our products may without notice make the information contained herein subject to alteration. For the latest information, please visit our website, www.aerushealthdirect.com.

This equipment has been tested and found to comply with the limits for Industrial, Scientific, and Medical Equipment (ISM), pursuant to Part 18 of the FCC Rules. These limits are designed to provide reasonable protection against harmful interference in a residential installation. This equipment generates, uses, and can radiate radio frequency energy, and if not installed and used in accordance with the instructions, may cause harmful interference to radio communications. However, there is no guarantee that interference will not occur in a particular installation. If this equipment does cause harmful interference to radio or television, which can be determined by turning the equipment off and on, the user is encouraged to try to correct the interference by one or more of the following measures:

Reorient or relocate the receiving antenna. Increase the separation between the equipment and receiver.

Connect the equipment into an outlet on a circuit different from that to which the receiver is connected.

Consult Customer Service or an experienced radio/TV technician for help.

FCC DECLARATION OF CONFORMITY

Name: Aerus Health Direct, LLC

Model: SimpleMist Humidifier

Manufacturer: Aerus Health Direct, LLC

This device complies with Part 18 of the FCC Rules.

RESPONSIBLE PARTY

Aerus Health Direct, LLC
300 East Valley Drive
Bristol, VA 24201
Ph: 888-236-7231

Signature: 

Printed Name: Andrew Eide

Title: Vice President of Product Development & Manufacturing

Date: 04.01.18



For information regarding this product visit

www.allergybuyersclub.com

(888) 236-7231

Aerus Health Direct, LLC 300 East Valley Drive, Bristol, VA 24201
Made in P.R.C ©Aerus Health Direct, LLC 2018
allergybuyersclub.com is owned and operated by Allergy Buyers Club, LLC