

# PowerPure<sup>®</sup> 3000

AERUS

## Ultrasonic Humidifier Owners Manual

Thank you for purchasing your new PowerPure Ultrasonic Humidifier.

This humidifier will help you to restore and maintain an appropriate level of humidity and eliminate the discomfort associated with dry air. We wish you many years of healthy indoor air with this high-quality appliance.

We recommend you spend some time reading this instruction manual in order to fully understand all the operational features it offers.

### Contents:

1. Technical Data
2. Features
3. Humidity Level
4. Safety
5. Operation
6. Trouble Shooting
7. Maintenance

### 1. Technical Data

Model: PowerPure 3000  
Electric supply: 120V 60Hz  
Power Consumption: 30W  
Water tank capacity: 1.18 gal.  
Evaporation Rate:  $\geq 0.79$  gal/Hr  
Noise level:  $\leq 35$ dB(A)  
Dimensions: 9,64" W x 8,46" D x 14,96" H

### 2. Features:

1. Cool mist humidification.
2. 360-degree nozzle for directing mist.
3. LED screen with digital humidity and temperature display.
4. Auto shut off: when water level is low.
5. Easy-to-use touch panel controls and included remote control.
6. Automatic humidity control maintains your desired humidity level.
7. Anion/ Ion function: Designed to ensure cleaner, healthier mist.
8. Water filter: The iron resin filter system softens, removes minerals and freshens the water in the tank.
9. Mist level adjustment.
10. Water level viewing window on right side.

### 3. Humidity Level:



Relative humidity is the amount of water vapor present in air expressed as a percentage of the amount needed for saturation at the same temperature. Atmospheric air always contains water vapor, the percentage of which depends on the meteorological conditions. The higher the temperature, the more water vapor can be held in the air. When the cold air is heated to a comfortable temperature in winter the relative humidity drops. In order to keep a comfortable and healthy environment at home, we need the addition of water or water vapor to the room air. For a healthy environment, we recommend maintaining a 40-50% relative humidity level.

### 4. Safety:

1. To prevent damage, remove all packaging containing the humidifier prior to starting the appliance.
2. Never disassemble the base unit. This appliance can only be repaired by professional, authorized repairmen.
3. Immediately discontinue use of the appliance in the event of a damaged power cord or plug. The power cord must be replaced by a professional, authorized repairman.
4. Do not add or clean with detergents or chemical solutions.
5. Unplug appliance during filling, cleaning and maintenance.
6. To prevent accidental, personal injury or damage to the appliance never insert foreign matter into air inlet or outlets.

7. Do not clean transducer with detergents, chemical solutions that are not recommended. Do not scrape the transducer.
8. Unplug the humidifier before cleaning and maintenance.
9. Children should be supervised to ensure that they do not play with the appliance.
10. This appliance is intended for indoor use only. Never use outside.
11. Do not operate this appliance in an environment where there is flammable and/ or explosive gases, and use in the direct sunlight should be avoided.
12. Do not place this appliance on uneven ground or in an unstable position.
13. Prior to cleaning or other maintenance, the appliance must be disconnected from the power supply.

**5. Operation:**

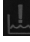
1. Place your humidifier on a flat surface.
2. Remove the water reservoir and fill cap and fill the water reservoir with cool, fresh water and then reinsert the fill cap tightly.
3. Place the water tank onto the main body.
4. Switch on the machine; the background light of the LCD screen will be on.
5. Press the  button, to adjust the mist level. On the remote control, press the mist volume button to adjust the mist volume.
6. Press the ION "Tree" button to utilize the negative ion generator for clean, fresh air. The Ion feature is operating when you see the tree icon on the LCD display. Press the ION button again to stop the negative ion generator.
7. Prior to pressing the HUMIDITY  button, the LCD display shows the current humidity level in your room. You may set the humidity arranged from 45%RH to 90%RH. Each time you press the button, the humidity setting will increase by 5%. When it reaches 90%, press once again to return to 45%. For a healthy humidity level we recommend setting your humidifier between 40% and 50%. After you set your desired humidity, the machine will display your setting for 5 seconds. After 5 seconds the LCD display will show the current humidity level. If the expected humidity is less than the current humidity, the machine will go into a sleeping state. If the desired humidity is higher than the current humidity, the humidifier will begin operation.
8. Timer: There are 12 timer settings: 1,2,3,4,5,6,7,8,9,10,11,12 hours. Press the TIMER button  and the LCD will display the shape of a clock. Continue to press the TIMER button to increase the timer setting from 1 to 12 hours.
9. Low Water:  Once the water in the basin is empty, your humidifier will automatically turn off. Refill the water, and the machine will restart.

**IMPORTANT!**

**STOP! Read directions before filling!**  
**Do Not Fill From the Top!**

**Instructions for Filling the PowerPure by Aerus 3000 Ultrasonic Humidifier**

The PowerPure by Aerus 3000 Ultrasonic Humidifier is designed for quick, safe filling of water.

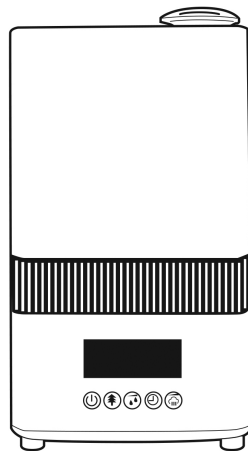

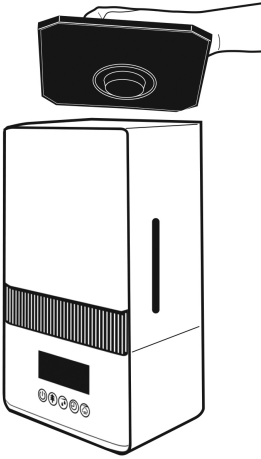

**STEP 1**

Firmly holding the mist nozzle at the top of the lid, gently remove the lid in an upwards direction. You will see the carry handle designed for transporting the water reservoir to and from your sink for filling. Place the lid to the side.

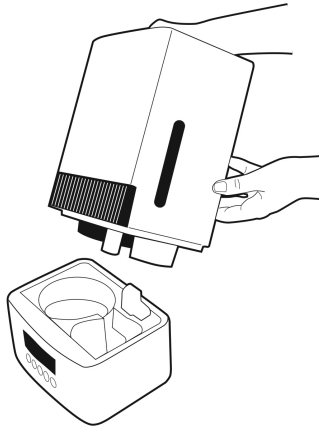

**STEP 2**

To remove the water reservoir, gently lift the water reservoir upwards from the humidifier base using the built-in carrying handle.

**STEP 3**



Once at your sink to fill the water reservoir, turn the tank upside down and unscrew the cap with combination water dispensing valve and permanent ceramic filter. Fill the reservoir completely with water and reattach the cap and valve assembly.

## 6. Trouble Shooting:

Check the following before requesting maintenance:

Trouble	Possible reasons	Shooting Way
Power lamp off, does not work	No power supply	Connect power supply, switch on
Power lamp on, no mist outlet with wind	No water in water tank	Fill water into water tank
	Security switch is too loose	Make the switch tight
Abnormal smell mist	New unit	Take out water tank, open cover, air out for 12 hours in cool location.
	Dirty water	Clean water tank, fill with clean water
Power lamp is on, unit doesn't work	Too much water in the water basin	Drain the water basin and water tank, close the cover of water tank tightly and restart
Mist is minimal	Too much scale in the water basin	Clean transducer
	Water level in tank is low	Fill water tank with fresh water
Abnormal noise	Unit is on an unstable surface	Move the unit to a stable flat surface
	There are apertures between the nozzle, lid and water tank	Dip the nozzle in water and then reinsert into the water tank
Mist is coming out from around nozzle or lid	The nozzle and top cover not put well	Correctly put the top cover and nozzle.

For assistance with operation or warranty repair, please call 1-888-236-7231 to speak with a customer service agent.

## 7. Maintenance:

In the instance that your water is hard, meaning that the water is rich with calcium and magnesium, a white powder problem can develop which leads to heavy scaling on the surface of the water basin, transducer and inner surface of the water tank. Scale on the surface of the transducer will prevent your humidifier from working properly.

We recommend the following:

1. Discontinue use of your tap water.
2. Use cold boiled water or distilled water.
3. Clean the transducer, water tank and basin unit every week.
4. Replace the water in the water tank more regularly to ensure freshness.
5. Remove the water from the water tank, clean all components of your humidifier and thoroughly dry before storing your humidifier for a prolonged period of time.

Cleaning:

1. Clean and activate the ceramic balls every 30 – 45 days depending upon use.
2. Remove ceramic ball filter from the tank cover.

3. Soak the ceramic ball filter in white vinegar for 10 minutes.

4. Remove ceramic ball filter system from the white vinegar and thoroughly rinse with cool, clean water.

Cleaning the transducer:

- 1) Put 5-10 drops of white vinegar on the surface of the transducer, wait for 2-5 minutes.
- 2) Gently remove any mineral scale from the surface of the transducer.
- 3) Use a damp, soft cloth to wipe clean the transducer.

Cleaning the basin unit:

Rinse the water basin with a damp, soft cloth to remove build up. In the event of scaling, pour a small amount of white vinegar and warm water into the basin and let soak for 5 minutes. Use a damp, soft cloth to wipe clean the basin and rinse clean with clean water.



**Disposal:** Please contact your local municipality for disposal instructions for small appliances.